

THE ANSWER IS SIMPLE

V-Ram Solids, Albert Lea, Minnesota

Differences in Municipal Sludge Pump Valve Systems Provide Clear Choice

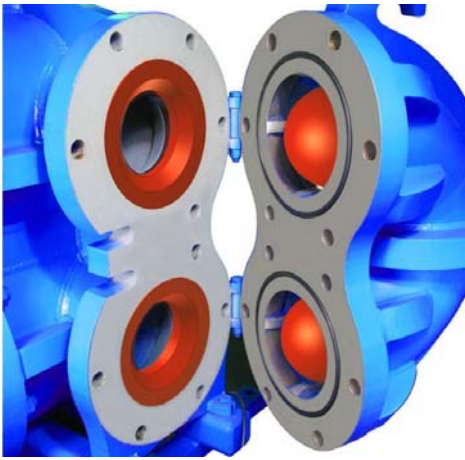

Ball check valves:

1. Have been in use for centuries in liquid/slurry applications with proven history of reliability and longevity.

2. Have self-cleaning action for rags and other materials which would normally block other types of valves.

3. Have been used by V-Ram Solids in municipal sludge cake pumps over 30,000 hours with no design or wear failures.

4. The effective wear surface of the valve ball is 50 times that of poppet valves. The urethane wear life is ideal for this application.

5. Ball valve components are readily accessible through hinged sections of the pump head and can be replaced within 2-3 minutes after the pump is opened.

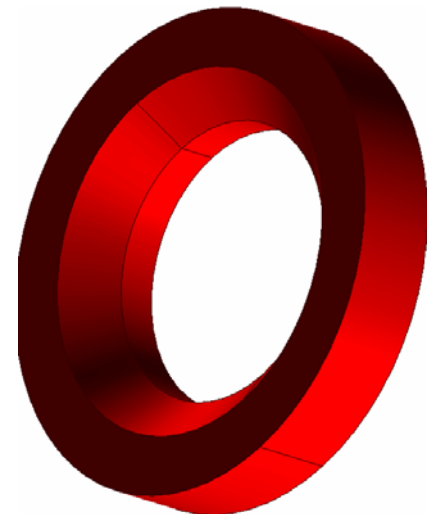
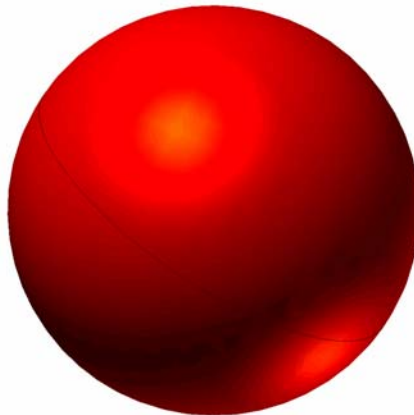
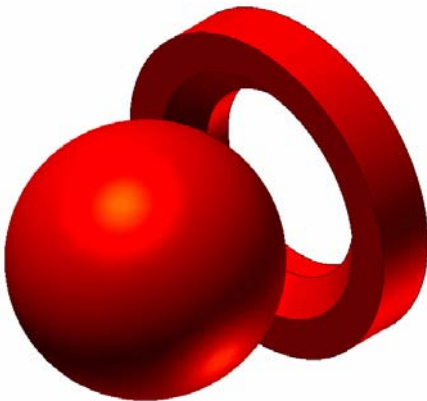

V-RAM Solids, 620 South Broadway, Albert Lea, MN 56007

Phone: (507)888-3996 Fax: (507)373-5937

Email: sales@vram.com Website: www.vram.com